

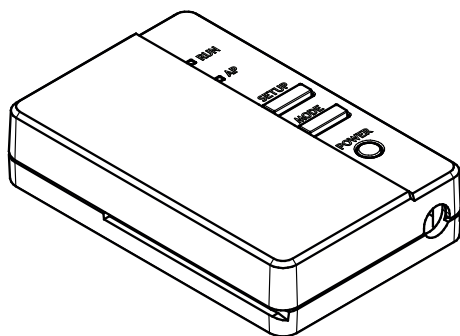

Wireless LAN Connecting Adapter Installation Manual

[BRP072B42]

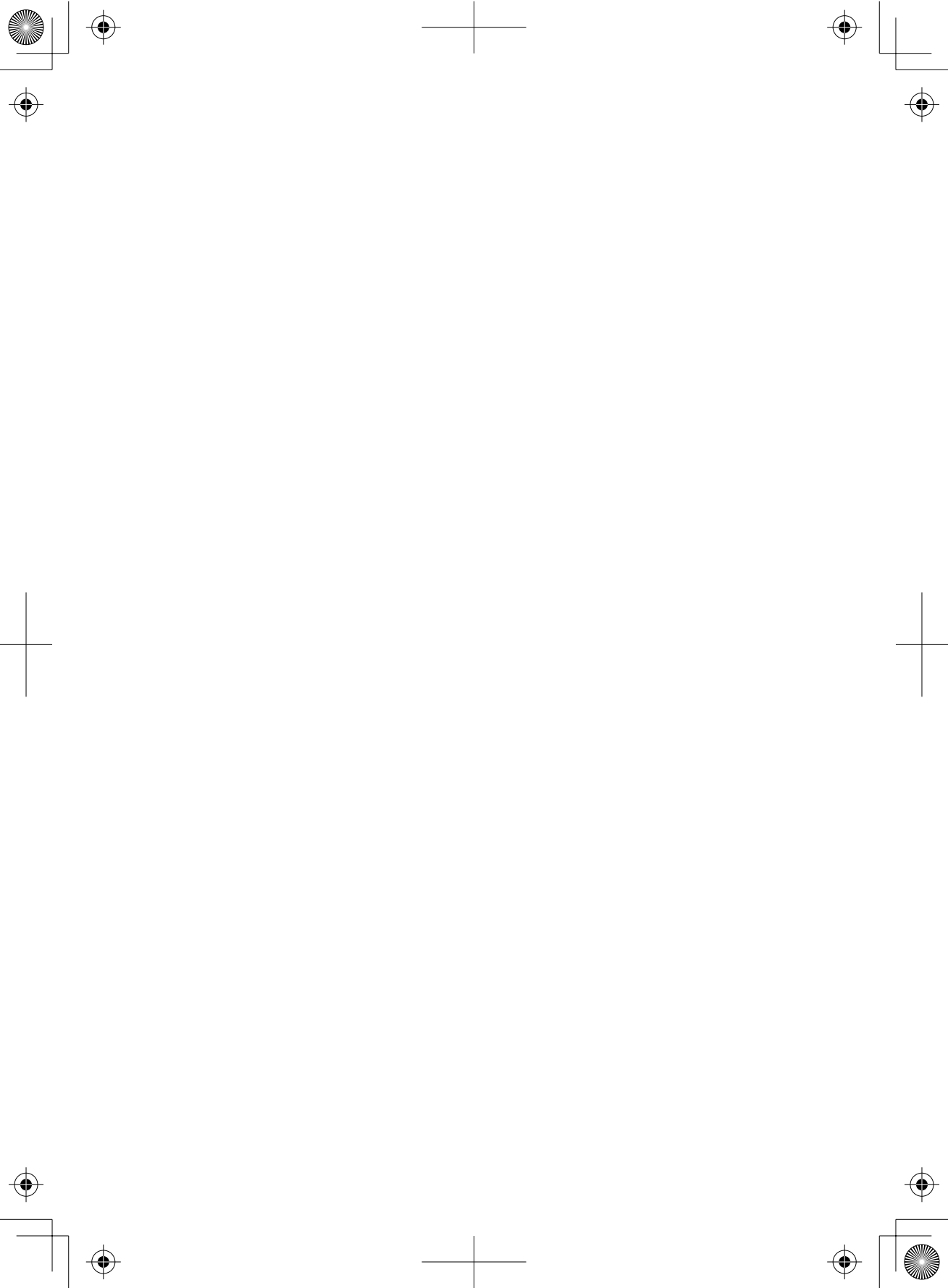





Wireless LAN Connecting Adapter
[BRP072B42]

Installation Manual

Website: <http://www.daikinthalai.com/wlan3/modbus>



- For details on specifications, setting methods, FAQ, and the latest version of this manual, see our website.

Accessories

Check if the following accessories are included in your package.

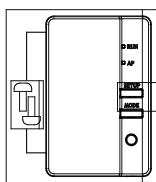

- (A) This set includes the following items:
Wireless LAN connecting adapter: 1 pc,
Serial number sticker (*1): 1 pc,
Screw (M3 × 8): 2 pcs.



- (B) Installation manual: 1 pc

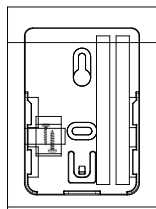

- (C) This set includes the following items:
Holder: 1 pc,
Double face tape: 2 pcs,
Screw (M3 × 16): 2 pcs.

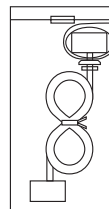

- (D) Wire harness assembly (*2): 1 pc

- Do not use the Wireless LAN connecting adapter for purposes other than wireless LAN communication. Not accessible to Internet networks.
- *1 • The serial number sticker is necessary for wireless connection settings.
Please keep it in a safe place.
- *2 • Do not use extension or other wire harness assembly.
• Some models already have this wire harness assembly installed in the indoor unit.

Safety precautions

- The following describes the meanings of pictorial symbols used in this installation manual.

Give this installation manual to the customer when installation is completed.

- To conduct a test run of the air conditioner, complete according to the installation manual for the air conditioner unit.



The protection of appliances marked with this symbol is ensured by double insulation and does not require a safety connection to electrical earth (ground).



Prohibited



Follow directions



WARNING

Situations which could result in death or serious injury.

When installing:



- Request installation by your dealer or a technician.
(Could cause electric shock or fire.)
- Always use the accessories and specified parts for installation. Be sure to follow the directions in this installation manual.
(Could cause the unit to fall, electric shock or fire.)
- Electrical work must be performed in accordance with relevant local and national regulations and with the instructions in this installation manual.
Always use a dedicated circuit.
(Could cause electric shock or fire.)
- Always turn off the power supply when installing.
(Touching the electrical parts could cause an electric shock.) The main switch of the installation is at the outdoor unit. Please switch off this main switch to turn off the power supply.

Safety precautions



WARNING

Situations which could result in death or serious injury.

When using:



- Do not disassemble, modify, or repair.
(Could cause fire, electric shock or injury.)
- Do not handle the Wireless LAN connecting adapter with wet hands.
(Could cause electric shock or fire.)
- Do not allow the Wireless LAN connecting adapter to get wet or use it when bathing or similar activities using water.
(Could cause electric shock or fire.)
- Do not use the Wireless LAN connecting adapter near medical equipment or persons using cardiac pacemakers or defibrillators. The Wireless LAN connecting adapter may cause life-threatening electromagnetic interference.
- Do not use the Wireless LAN connecting adapter near auto-control equipment such as automatic doors or fire alarm equipment.
(Could cause accidents due to erroneous equipment behavior.)



- Immediately turn off the circuit breaker if there is abnormal odor or sound, when it is overheating, or smoking.
(Could cause fire or malfunction.)
 - Request an inspection by your dealer.
- Turn off the circuit breaker if the Wireless LAN connecting adapter was dropped or the case is damaged.
(Could cause fire or electric shock.)
 - Request an inspection by your dealer.

Safety precautions



CAUTION

Situations which could result in damage or physical injury.

When installing:



- Do not install where flammable gas leaks can occur.
(Could cause fire.)



- Grip the connector when disconnecting the wire harness assembly from the outlet.
(Otherwise fire or electric shock can occur.)

When using:



- Do not use where small children can get access.
(Could cause injuries.)

- Do not use this product near a microwave oven.
(This can affect Wireless LAN communications.)

Main components

Wireless LAN connecting adapter

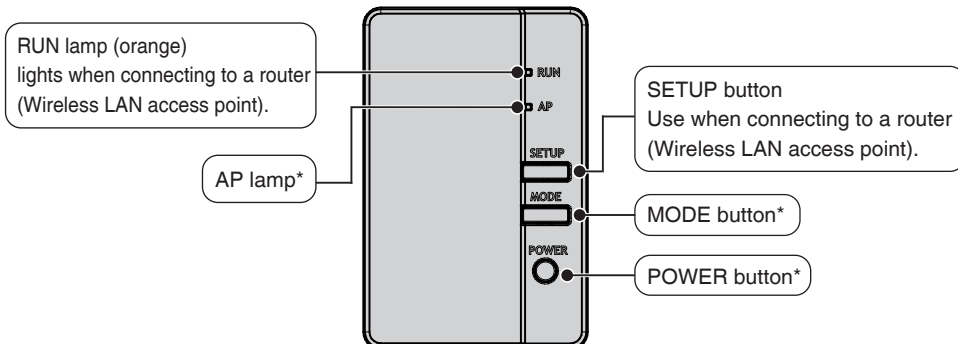

* No operation for BRP072B42 model.

Installation type **A**

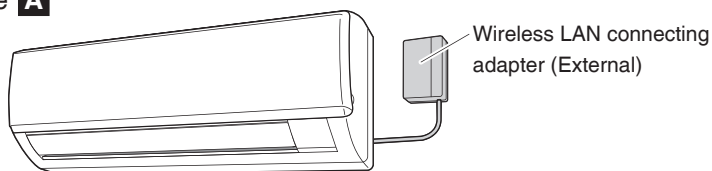

Installation type **B**

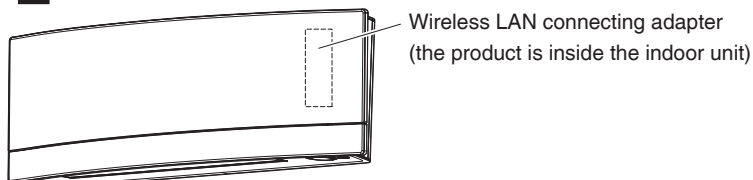

Basic parameters:

Frequency range:	2400 MHz–2483.5 MHz
Radio protocol:	IEEE 802.11b/g/n
RF channel:	1–13
Output power:	0 dBm~18 dBm
ERP:	17 dBm (11b) / 13 dBm (11g) / 12 dBm (11n)
Power supply:	DC 14 V / 100 mA

RF channel: Radio frequency channel

ERP: Effective radiated power

Applicable indoor units

For more details about installation of Wireless LAN connecting adapter and applicable units visit <http://www.daikinthalai.com/wlan3/modbus>

Installation

Installation Work



WARNING

Always turn off the power supply when installing.
(Touching the electrical parts could cause an electric shock.)
The main switch of the installation is at the outdoor unit.

The steps to be followed depend on the installation type: type **A** = External, type **B** = Internal.

1 Choose an installation site. (In the case of **A**)

The Wireless LAN connecting adapter should be sited in a place where:

- The Wireless LAN connecting adapter is not in the path of direct sunlight.
- The Wireless LAN connecting adapter is away from the source of heat or steam.
- There is not source of machine oil vapour (this may shorten the Wireless LAN connecting adapter life).
- The Wireless LAN connecting adapter is at least 1 m away from any television or radio set (The Wireless LAN connecting adapter may cause interference with the picture or sound).
- Distance between the indoor unit and the Wireless LAN connecting adapter is within length of Wireless LAN cable.

2 Attach the Wireless LAN connecting adapter to indoor unit.

■ In the case of **A**

Attach wire harness assembly **(D)** to indoor unit.

Remove the front grille of the indoor unit, then connect the connector of wire harness assembly **(D)** to the white "S21" connector on the electrical wiring box.

- For instructions on how to remove the front grille or run the wire harness assembly **(D)** into place, see the installation manual of the particular air conditioner.
(Wire harness assembly **(D)** can connect to wire harness assembly HA.)

⚠ Danger

Always turn off the power supply when installing.
(Touching the electrical parts could cause an electric shock.)

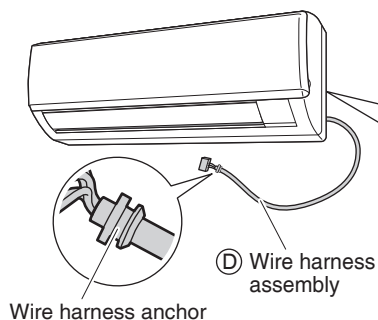

Connector

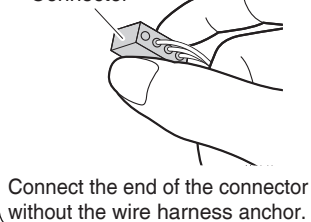

- If there is no white "S21" connector, install a separate printed circuit board into the indoor unit.

Installation

Installation
Work

■ In the case of **B**

- Some models already have the wire harness assembly ① installed in the indoor unit. In such a case, please proceed with the installation as below.
Remove the upper front panel from the indoor unit and open the door, grab the wire harness assembly with your fingers and pull it out, then remove the binding band and pull the insulation tube off the wire harness assembly.
- Refer to your air conditioner's installation manual for details on removing the upper front panel.

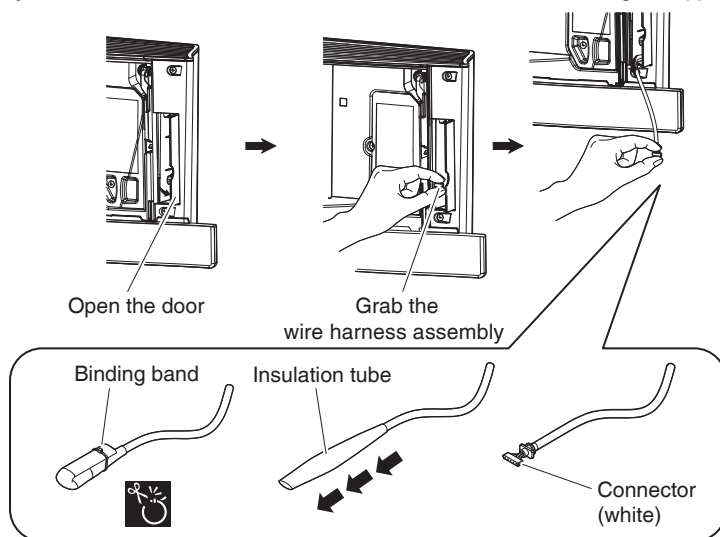

3 Remove the Wireless LAN connecting adapter case (upper). (For both **A** and **B**.)

Remove the upper case of the Wireless LAN connecting adapter.

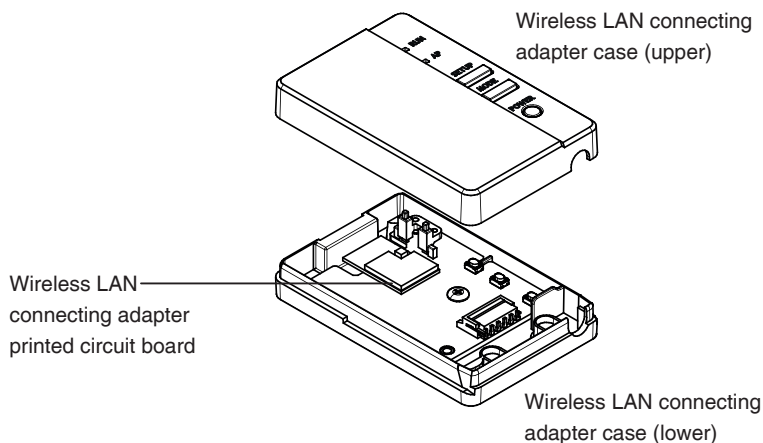

Installation

Installation Work

4 Attach wire harness assembly to the Wireless LAN connecting adapter. (For both **A** and **B**.)

Attach the wire harness assembly connector (white).

- Fasten the wire harness assembly to the notch in the Wireless LAN connecting adapter case (lower). Connect the connector to the same color.

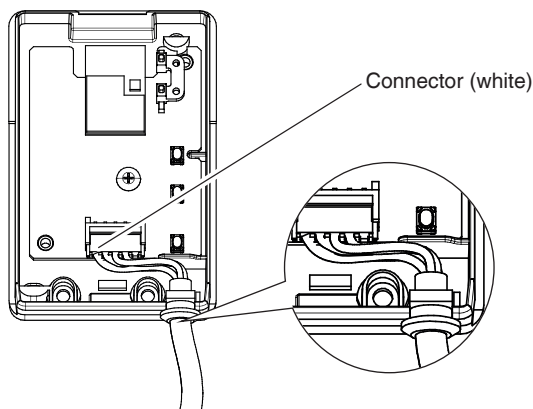

Fasten the wire harness assembly and ensure that external force is not transmitted.

5 Return the Wireless LAN connecting adapter case to its original state. (For both **A** and **B**.)

Snap the top of the upper case onto the clip at the top of the lower case and press to close the box.

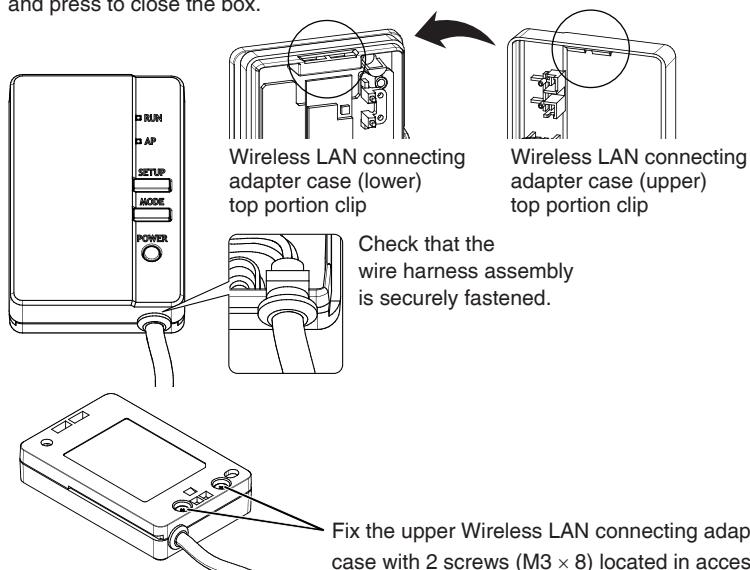

Installation

Installation
Work

6 Installation of Wireless LAN connecting adapter.

■ In the case of **A**

Install the Wireless LAN connecting adapter outside the indoor unit. There are two ways of installation A1 and A2.

TYPE A1

Position of the Wireless LAN connecting adapter on the wall/surface is fixed by screws. In this case double face tapes located in accessory set are not necessary to fix the holder.

1. Fix the Wireless LAN connecting holder on the wall/surface with 2 screws located in accessory set.
2. Attach the Wireless LAN connecting adapter to the holder by sliding into it.

For more details about installation of Wireless LAN connecting adapter to your model please visit <http://www.daikinthalai.com/wlan3/modbus>

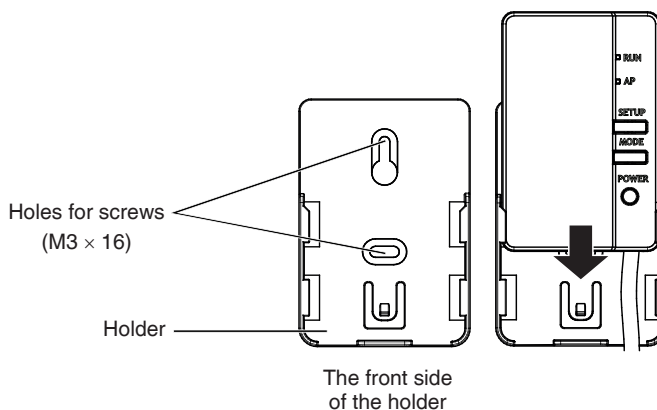

Installation

Installation Work

TYPE A2

Position of the Wireless LAN connecting adapter on the wall/surface is fixed by double face tapes. In this case screws located in accessory set are not necessary to fix the holder.

1. Attach two double face tapes located in accessory set to the back side of holder as shown below.
2. Fix the Wireless LAN connecting holder on the wall/surface with the double face tapes.
3. Make sure that holder is fixed to the wall/surface enough to support the Wireless LAN connecting adapter.
4. Attach the Wireless LAN connecting adapter to the holder by sliding into it.

NOTE

Wall/surface should be clean and degreased before attaching of the Wireless LAN connecting holder by double face tapes.

For more details about installation of Wireless LAN connecting adapter to your model please visit <http://www.daikinthal.com/wlan3/modbus>

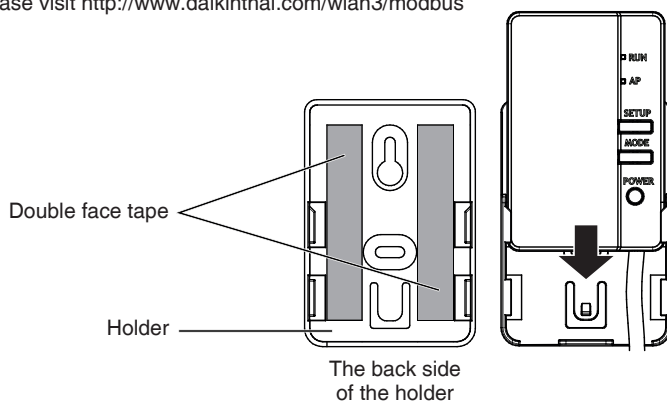

■ In the case of **B**

Grab the adapter case with your fingers, insert it back into the indoor unit and close the door.

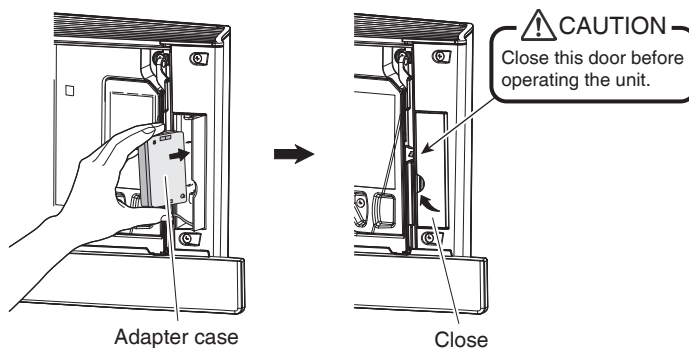

Installation

Installation
Work

7 Functionality Check

■ In the case of **A**

Turn on the main power supply and check that the [RUN] lamp of the Wireless LAN connecting adapter blinks.

■ In the case of **B**

Turn on the power supply, wait until the initialization is completed (the lower panel is in the closed position). Open the door, remove the Wireless LAN connecting adapter and check that the [RUN] lamp for the product lights. After checking, return the Wireless LAN connecting adapter into the unit and close the door.

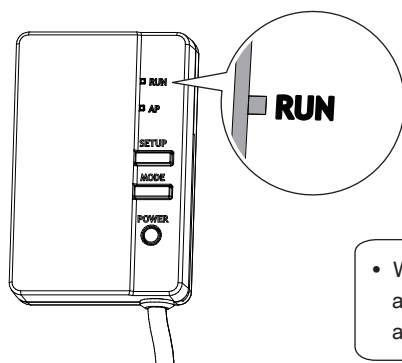

- When turning on the power, always attach the Wireless LAN connecting adapter case (upper).

Configuration

Wireless Connection
Setting Section

The customer is responsible for providing the following:

- Additional devices such as smartphones, tablets, desktop PCs, laptops or other devices that can be used as the interface between the Home gateway controller and the Wireless LAN connecting adapter
- Communication devices (modem/routers or similar devices) which are able to connect between the Home gateway controller and the Wireless LAN connecting adapter

Simple Wireless Connection Setting

The setup is simple if there is a [WPS] button on the router (Wireless LAN access point).

1 Check that the [RUN] lamp is blinking.

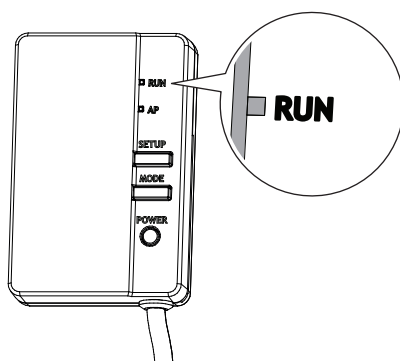

2 Push the [WPS] button on the router (Wireless LAN access point).

- Operation of the [WPS] differs according to the router (Wireless LAN access point).
- Please refer to the documentation that comes with your router for more information.

Does your router have a [WPS] button?

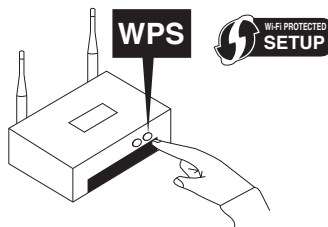

For more information, see the manual of your router.

Configuration

Wireless Connection Setting Section

- 3** Push the [SETUP] button on the Wireless LAN connecting adapter for approximately 2 seconds.
 - The [RUN] lamp on the Wireless LAN connecting adapter blinks more quickly.
When the Wireless LAN connecting adapter and the router (Wireless LAN access point) are connected, this lamp lights. If you fail to connect, please try again from step 1 of "Simple Wireless Connection Setting". (It may not be possible to make the "Simple Wireless Connection Setting", depending on compatibility with the router.)
- 4** After connecting the Wireless LAN connecting adapter to the router, the user will be able to detect the Wireless LAN connecting adapter via Home gateway application.

[About the SSID and KEY]

The [SSID] and [KEY] shown on the serial number sticker which is included in the accessories (A) are necessary when connecting the air conditioner and a smartphone via Wireless LAN. Please keep them in a safe place.

Wireless Connection Setting

For Wireless LAN connecting adapters which cannot connect to communication devices by [WPS] mode, please refer to our website, which explains procedures for the manual connection mode (<http://www.daikinthalai.com/wlan3/modbus>).

Troubleshooting

The following table provides brief descriptions of how to handle trouble or uncertainties when you install the Wireless LAN connecting adapter or make connection settings.

Refer to the FAQ on our website for more details.

When this happens	Explanation and where to check
None of the LEDs light.	<ul style="list-style-type: none"> • Try to operate the unit with the infrared remote controller. • Turn off the air conditioner and restart it. • Make sure the LEDs are not disabled in the application. • Check the installation.
The Wireless LAN connecting adapter is not visible on the Home gateway controller / Home gateway application after the Wireless LAN connecting adapter has been configured.	<ul style="list-style-type: none"> • Check that the power is on. • Check that the [RUN] lamp is lit. • If the [RUN] lamp is blinking, retry to connect the Wireless LAN connecting adapter to the wireless network. Make sure the Wireless LAN connecting adapter is close enough to the router (Wireless LAN access point). • If the [RUN] lamp is lit, make sure that Home gateway controller or Home gateway application is connected to the same Wireless LAN network as the Wireless LAN connecting adapter. <p>Please refer to the documentation that comes with your Home gateway controller / Home gateway application for more information.</p>
None of the above work.	<ul style="list-style-type: none"> • Refer to the FAQ on: http://www.daikinthalai.com/wlan3/modbus

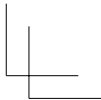
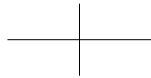
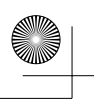

MEMO

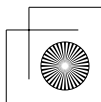
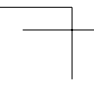

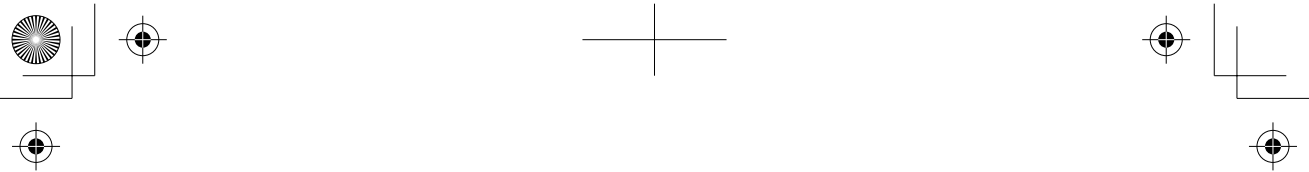

MEMO

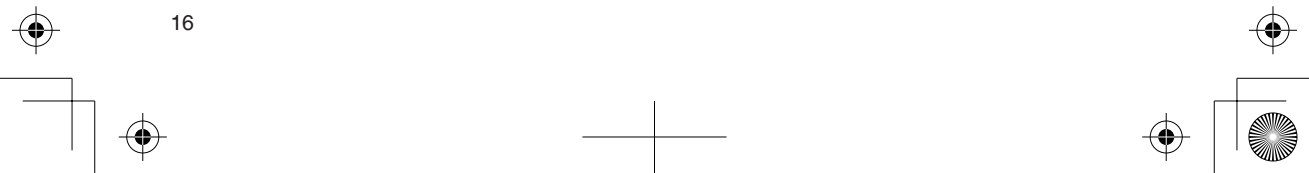

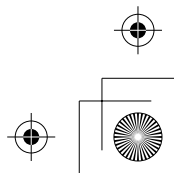
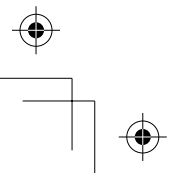
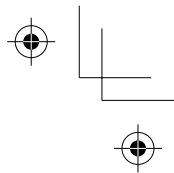
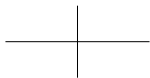
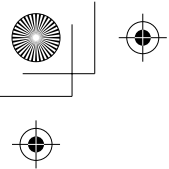

DAIKIN INDUSTRIES, LTD.

Head office:

Umeda Center Bldg., 2-4-12, Nakazaki-Nishi,
Kita-ku, Osaka, 530-8323 Japan

Tokyo office:

JR Shinagawa East Bldg., 2-18-1, Konan,
Minato-ku, Tokyo, 108-0075 Japan
<http://www.daikin.com>

This telecommunication
equipment is in compliance with
NTC requirements.

Complies with
IMDA Standards
DA107930